

BALE CUTTER SBS



Application:

The Hauer bale cutter SBS was developed for the cutting and portioning silage, straw or hay bales for feeding, for up to 1800 diameter bales.

Description:

The SBS consists of a thick-walled tine tube and a sturdy frame. The bales are fixed by four heavy duty tines with \varnothing 50mm and a length of 1000mm and the large opening width. They are cutted cleanly and quickly with the robust down holder with toothed bar.

In addition to the four tines, two tines outside can be retrofitted to transport two bales next to each other. An optional film catcher for clean separation of film/net and silage is available. The optimal design holds the film securely in place and ensures that only a small amount of material remains in the film. The film holder is controlled by a pressure sequence valve, which means that no additional hydraulic function is required.

The use of high quality materials, ensures a sturdy design and a low net weight for the use with front loaders on tractors. The SBS is also available with 3-point attachment. Alternatively, a combined attachment of 3-point and SWE-Euro can be ordered. This makes the SBS a universal tool that is equally suitable for use on front loaders or in the front or rear linkage. A pressure relief valve is required for 190 bar and higher pressures.



INNOVATION WITH TRADITION FOR LIFE.

Advantages:

- heavy-duty build
- large opening width
- extended side section of the cutting arm for protection of the cutting edge when parking
- down holder with ball joint bearing

Standard specification:

- 4 heavy duty tines 1000mm
- SWE-EURO mount or SWE-Hauer mount
- Standard Hauer orange or Hauer matt black paint finish

Options:

- film catcher
- 2 heavy duty tines outside 1000mm (prepared for with sleeve in basic device)
- paint finish available in all RAL colours
- pressure relief valve for working pressure higher than 190 bar
- 3-point attachment instead of Euro or Hauer attachment
- combined 3-point and Euro attachment
- multiple mount options

Technical data:

Opening width mm	Width mm	Tine length mm	Weight kg
1465	1794	1000	405

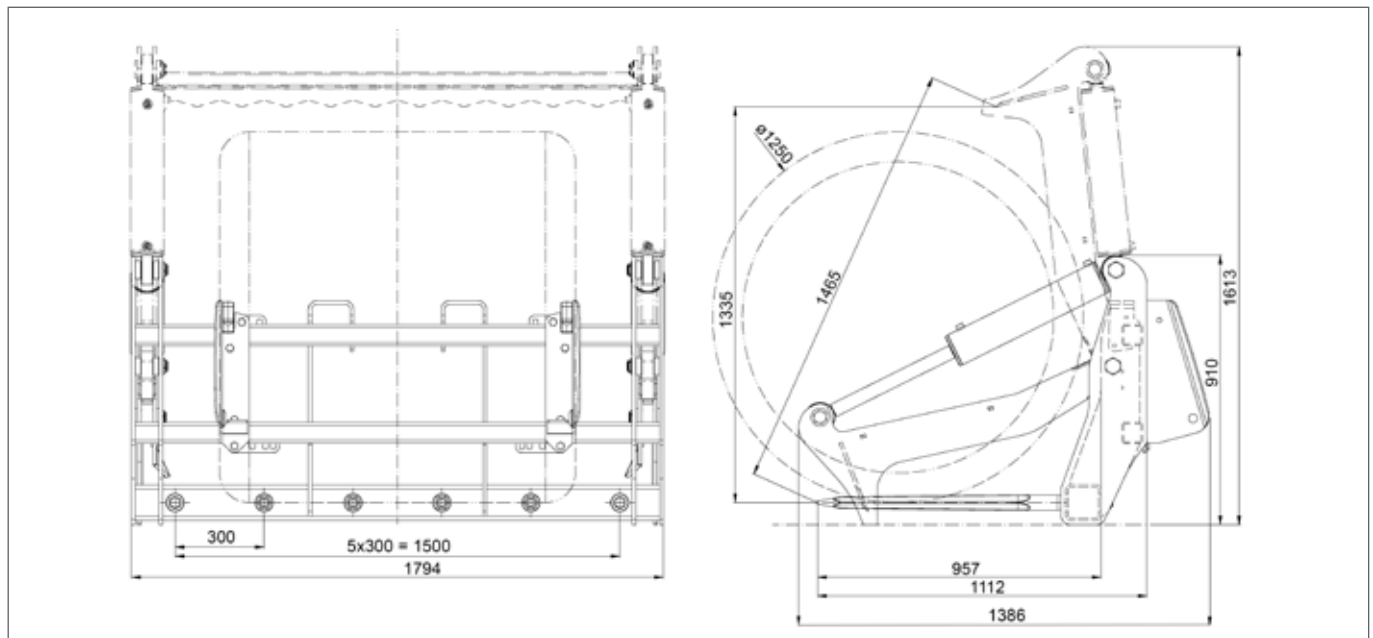

SBS with film catcher in use

© Hauer 2025/09. The illustrated products may differ from standard specification products. Subject to errors and changes.



Franz Hauer GmbH & CoKG, A-3125 Statzendorf, Werksstraße 6,

Tel.: +43 / (0)2786 / 7104-0, info@hfl.co.at | www.hfl.co.at