

FORESTRY GRAB BUCKET FGS-2

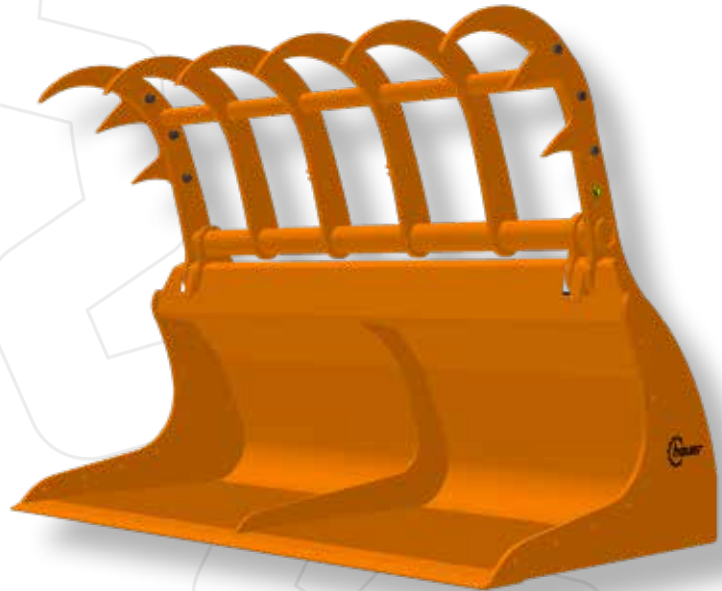

Application:

The forestry grab bucket is the ideal tool for handling clippings, brushwood and other coarse materials. Formed like a bucket, the attachment is equally home at digging and grading.

Operating principle:

To withstand the challenging forestry conditions, the forestry grab bucket has massive 15mm sides and thick wear strips on its base. The sturdy and curved tines are operated by powerful rams making efficient use of the available volume and securing the material in the grab. The cutting edges are made from hardened and wear-resistant 450HB steel. This enables a long lifespan.

The forestry grab bucket is also available with screwed side blades for handling bulk cargo and extra versatility. The welded cutting edge on the base receives additional protection from a second and reversible cutting edge that is bolted in place.

Advantages:

- Heavy-duty build
- Massive 15mm side plates
- Reinforced wear strips
- Curved tines and massive hydraulic cylinders ensure a firm grip of the material

Standard specification:

- SWE-EURO or Hauer carriage
- Standard Hauer orange or Hauer matt black paint finish
- Down holders with two hydraulic cylinders
- Teeth are mounted on the sides



INNOVATION WITH TRADITION FOR LIFE.

Options:

- Multiple mount options
- Pressure relief valve for up to 190bar operating pressures
- Paint finish in all RAL colours
- Side plates, screwed (can also be used as silage grab bucket with this option)
- Grid for short-fibre silage
- Second cutting edge

Width B mm	Volume full to the brim m ³	Nominal volume m ³	Depth T mm	Height H mm	Opening width W mm	Grab tines / bearings / strengthener	Weight kg
1600	0,59	0,82	1020	710	1310	6 / 2 / 1	476
1800	0,67	0,92				6 / 2 / 1	501
2000	0,74	1,02				6 / 2 / 1	526
2200	0,82	1,13				8 / 2 / 2	592
2400	0,89	1,23				8 / 2 / 2	614

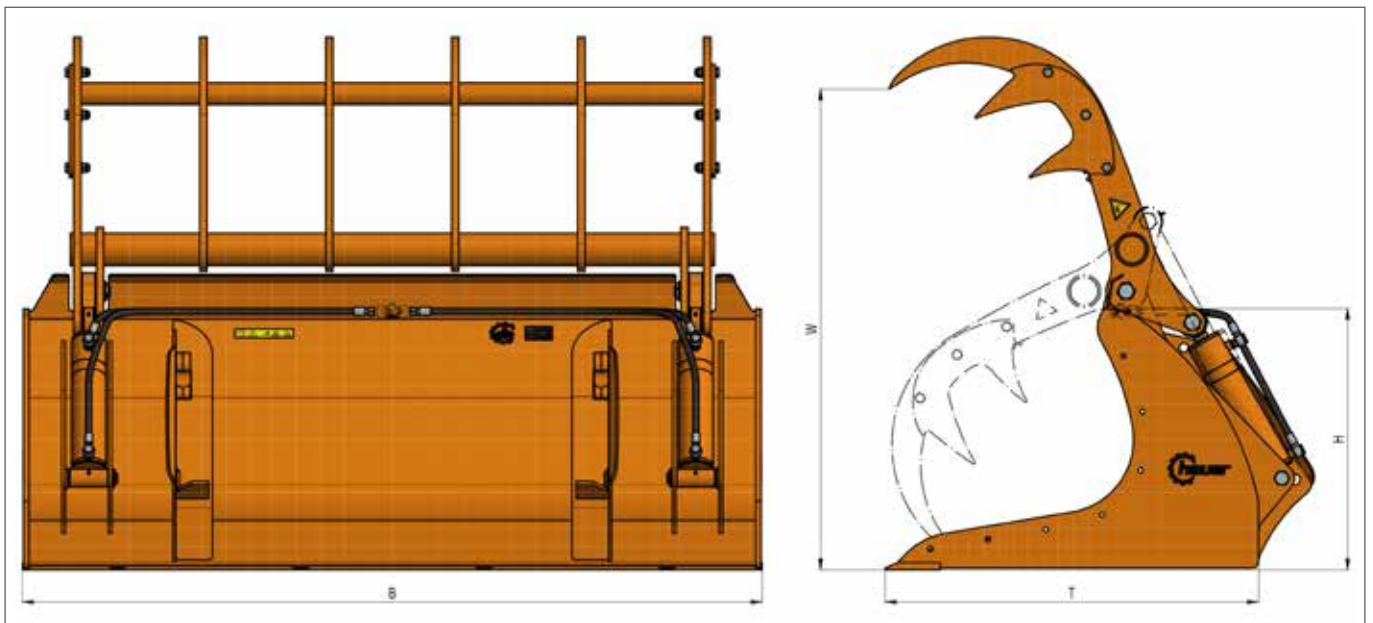

Grid

© Hauer 2024/11. The illustrated products may differ from standard specification products. Subject to errors and changes.